

A 2-piece stainless steel tank valve tested and proven to 5000 psi. Laboratory and independent FEA design conformation. Anti-blow-out stem design with top bearing ensures continual reliable performance. Ideally suited for use in and around CNG transportation units, all Sweet Natural Gas, inert and non-corrosive gas applications. Manufactured and designed in accordance to ISO 9001/2008.

Operation:

MAWP 5000 psi (345 bar)
 Temperature - 40°C to 80°C (Based on standard seals)

Port Connections:

NPT (std) (N)
 SAE (S)
 BSPP (B)

Features:

- Tested to 4:1 safety factor
- Anti- blow-out stem
- Bi-directional
- Delrin AF seats as standard
- Low torque operation
- Floating ball principle
- Multiple handle configurations
- Machined threaded port connections
- Fully serviceable, all kits available

Materials:

Body 304 Stainless Steel
 End Caps 304 Stainless Steel
 Ball 304 Stainless Steel
 Stem 304 Stainless Steel
 Seats Delrin AF Standard
 O' Rings Nitrile
 Handle 304 Stainless Steel

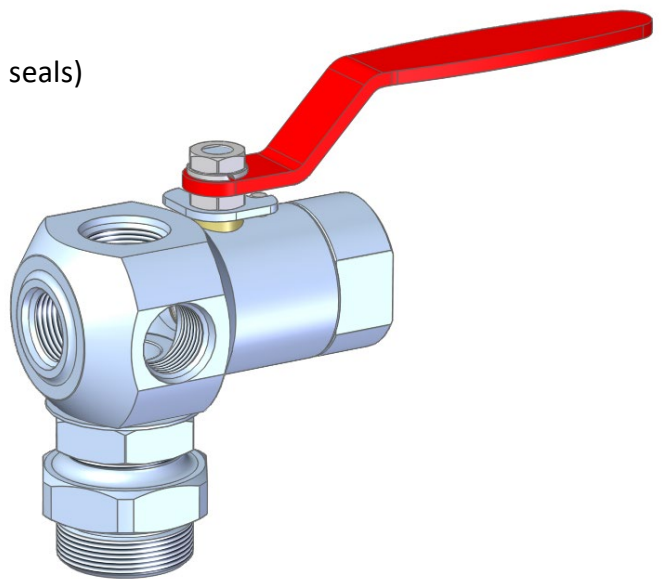

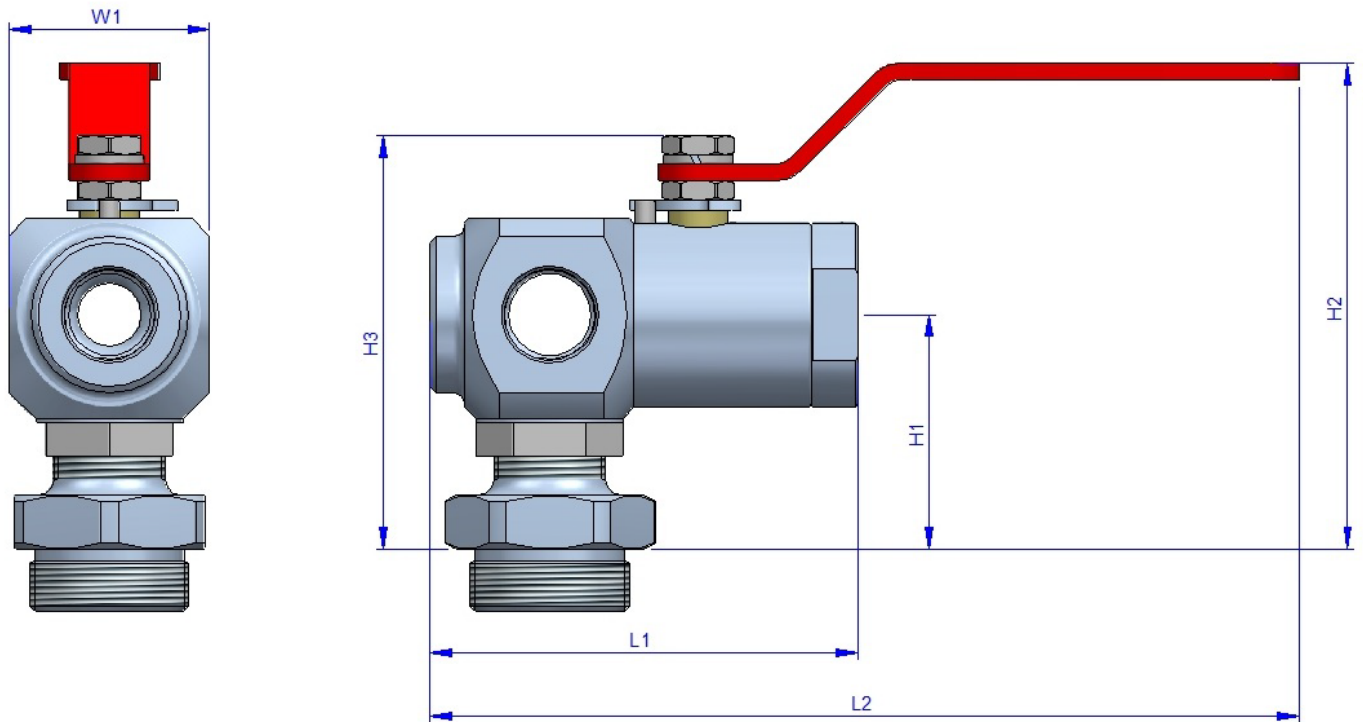

Inlet	L1	L2	H1	H2	H3	W1	Model #
20mm	118	250	67	142	121	60	VTS-1216
25.4mm	128	260	70	145	123	74.5	VTS-1220

Ordering Information:

Please supply the following information when ordering:

- Flow Medium
- Port Configuration
- Operating Temperature Range
- Operating Pressure Range